

Freedconn focuses on providing convenient, safe, and free communication for people who are pursuing a personal life. Providing health, happiness, freedom and enjoyment are the key words that FreedConn have a good riding communication equipment

The accessories used in each of FreedConn's products are tested and selected carefully by technicians, it creates the most cost-effective outdoor riding communication equipment for customers, making everyone assigns to the riding communication device.

Freedconn not only brings consumers the healthiest, happiest, free and enjoyable life experience, but also takes the unique cultural connotation and individuality with the brand exudes. We sincerely hope the rider who uses FreedConn's products have the wealth, health, freedom and enjoyment!



1. Main Features

- 1, With Camera Function
- 2, With WiFi(for video viewing or downloading)
- 3, Connect to the Walkie-talkie
- 4, Connect to MP3/GPS/Mobile phone
- 5, Voice Prompt
- 6, Audio mixing for Music,GPS&voice prompt
- 7, Voice command(Activating for Siri)
- 8, Available for using while charging

2. Functional diagram

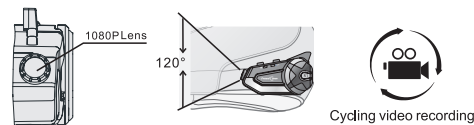

1 1080P 120° Wide Angle lens / Cycling video recording



2 It can be simultaneously connected with two mobile phones, Conducting your mobile while riding.



4 Bluetooth,v5.0 5 Capturing 6 Wifi Transferring 7 Voice prompt



8 Noise analogue modulation 9 Water-proof 10 Rechargeable battery(usable during recharging) 11 Voice Command

3. Product details

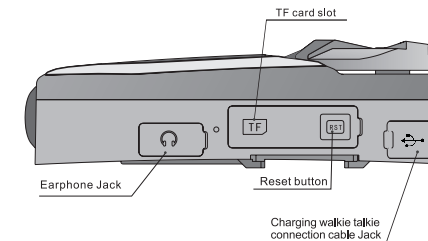
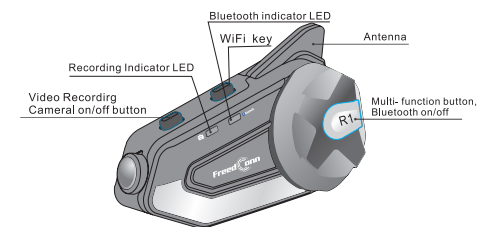

4. Multi-functional Button



1. **Bluetooth on:** hold down the multifunction key for about 3 s,when you hear the voice prompt: "Welcome to use Freedconn product" and release your hand
2. **Bluetooth off:**hold down the multifunction key for about 5 seconds, when you hear " Power off "and release your hand
3. **Bluetooth pairing:**In shutdown state, hold down the multifunction key 6s untill, you hear the voice prompt of "Pairing", release your hand, the indicator LED will flash in red and blue
4. **Answer calls:**After the Bluetooth intercom earphone has been paired with the mobile phone,press the one time ultifunction key to pick up,if no any action, the call will be picked up automatically in 10 seconds
5. **Reject calls:**For incoming calls, hold down the multifunction key for 2s, then release your hand when you hear "Di"
6. **Audio switching:**During the call, hold down the multifunction key for 2 s,when you hear "Dong", release your hand.

7. **Terminate call:**Press one time the multifunction key to terminate phone talking
8. **Siri activating(or to finish the siri function on the phone):** Double-click the multifunction key to activate siri function on the phone or to finish the siri function on the phone
9. **Music play/Pause/Control:**Press one time the multifunction key
10. **Turn on Bluetooth:**When the voice prompt "Welcome to Freedconn products"when you double-click the multi-function button to switch between Chinese and English.

5. Knob

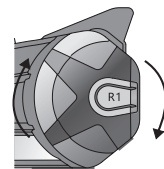

1. **Volume adjustment:**During call/intercom/music playing, turn the control knob clockwise to increase the volume, when the volume has reached maximum, you will hear the prompt sound "Dudu".Turn anti-clockwise to reduce the volume. When the volume reaches minimum, you will hear the prompt sound "Du".
2. **Rrev/Next song:**When playing music, turn the knob anticlockwise to the previous song. Turn the knob clockwise to the next song.

6. Function & Operation details for keys "Power" and "WiFi"

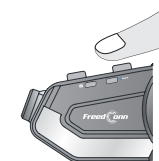

1. **Camera function:**
 - (1). Hold down the key "Power" 3s. to start, and press one more time "Power" to enter video recording status, you'll hear "video recording started".(every 3 minutes for one video segment.)
 - (2). Press "Power" again to stop recording, you'll hear "recording paused"when it is recording, the LED lasts with green color, or will flashes frequently. (When the card storage is full, the first video will be cycling recorded and the replaced automatically.)
 - (3). If no memory card inside, you'll hear "Please insert a memory card"(Supports Max. 64G memory card).
2. **Capturing function:** Short press the "WiFi" key for capturing.
3. **WiFi function:**
 - (1). Under the status of "cameral on", hold down the "WiFi" key for 2-3 seconds to turn on WiFi, you'll hear "WiFi turns on" and the green LED flashes one time every 0.5s ;
 - (2). With WiFi enabled, press and hold the "WiFi" button for 2 seconds to turn off WiFi. The green light flashes once every 2 seconds.



7. How to connect to R1's WiFi and view video/photo on your phone?



1. Download (GoPlus Cam) APP to your mobile phone
2. Hold down the WiFi key to open WiFi,
3. Choose FreedConn in the mobile WiFi list and input password "12345678" to connect to R1 WiFi
4. Back to the APP to view the video and photos on your mobile phone

8. Time Setting

1. Download the (GoPlus Cam) APP to your mobile
2. Turn on WiFi on R1
3. Searching WiFi on your mobile
4. Open the "GoPlus Cam" app and click on the version number in the lower left corner. Pop up the wifisport com time, select "Enable", enter Line time setting.
2. Create txt format file, rename it as userconfig. txt, edit content format as (XX Year-XX Month-XX Date XX Hour: XX Minute: XXSecond,)e.g.,2018-04-23 14:51: 52, save. Then copy it to the root directory of the TF card, insert the card to the R1, then start it up, the time is successfully set. Shut down the R1 and pull the TF card out and delete the file.

9

9. Pairing with Mobile Phone, MP3 and GPS

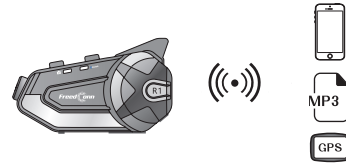

- Step I: make sure R1 is shut down, place the device to be paired within 1 meter visible scope.
- Step II: in shut down status hold down the multifunction key for 6 seconds, R1 will automatically enter pairing status. At this moment, the blue LED flashes in red & blue alternatively.
- Step III: turn on the Bluetooth of the device to be paired, search and select R1 to pair, you will hear voice prompt " connected", after the indicator LED turns to blue, it means pairing has been successful.

10

10. Technical Specifications

Frequency: 2.4GHz
 Weight: 77 grams
 Size: 98mm (L) x58mm (W) x30mm (H)
 Battery capacity: 1500mAh
 Compatible Power adapter: DC 5V/1A
 Lens: 1080P
 Phone Talking: 30 hours
 Video recording: 4.5 hours
 Charging time: about 2 hours
 Standby time: 12 days
 Music time: 48 hours

11. Battery Power Indication

1. When the battery is full, and Bluetooth is connected, blue LED will flash 1 time every 6s; if not connected, it will flash 2 times every 6s
2. When the battery is <3.5v for bluetooth, you'll hear "Battery low". When the voltage is <3.2V, it will automatically turn off. When the DVR voltage is <3.65V, when you hear "low battery", there will be a "beep" every 60 seconds. When the power is <3.5V, the battery is low and the DV is automatically turned off.
3. When it is in the charging status, the LED stays with Red color. And when the battery was fully charged, the LED will fade off.

11

12. Function Priority

1. Telephone call
2. PTT conversation
3. Music/Gps/Voice prompt

13. Installation Steps

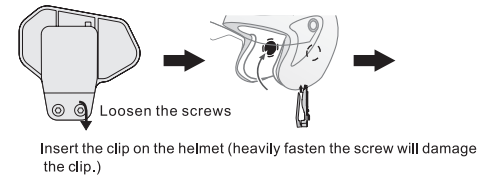
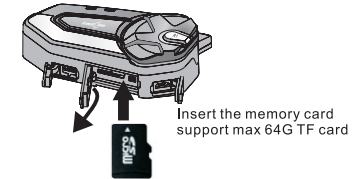

12

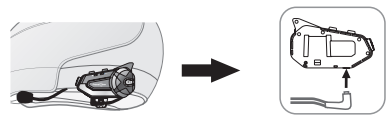
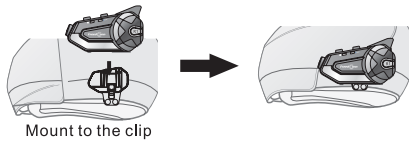

Insert the headphone plug into the jack on BT receiver to finish the installation

14. Disassembly of Bluetooth Device

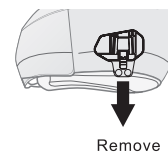
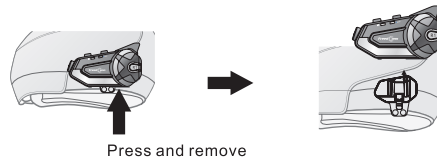

15. Daily Maintenance

1. Do not place R1 at a place subject to ultra high / low temperature, optimum storage ambient temperature is -40 degrees to +60 degrees, otherwise the service life of R1 will be compromised;
2. Do not expose R1 to naked fire, otherwise explosion may occur;
3. Do not expose R1 to sharp object, otherwise scratch or damage may occur;
4. Do not attempt to disassemble R1;
5. If the machine is not in use for a long time, make sure to keep it at dry place, if it is in storage for over one month, recharge the machine at regular interval, so as to maintain the operating performance of R1.

14

16. Pack Content

1. R1 device
2. Microphone & speaker
3. Clips
4. Screw driver
5. PTT VELCRO tape
6. Headphone Velcro
7. USB cable
8. Walkie-talkie PTT control cable

15

Warranty Card

Model Number : R1

2 Year Warranty

Please keep your purchase receipt together with your warranty card & "invalid if removed" label

Name: _____

Address: _____

After sale service: service@fdcdz.com

Failure Description:

Please affix a copy of invoice on the back of warranty card as a proof of purchase date. If you find any problems during use of our product, please contact our after sale service. Please make sure that you describe the problems clearly on warranty card so that we can handle them timely.

13